

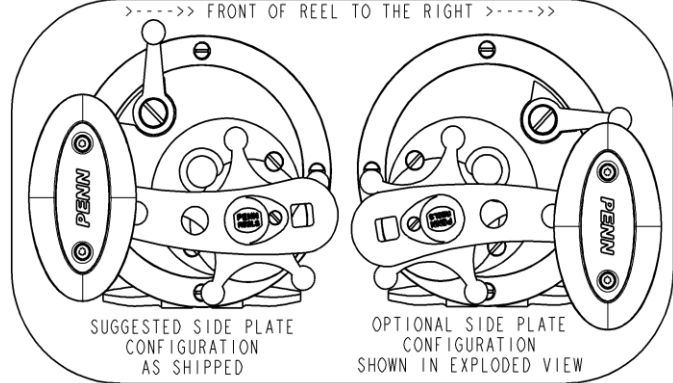

**PARTS FOR US113 (1338208) US113N (1338207) US113W (1338209)**

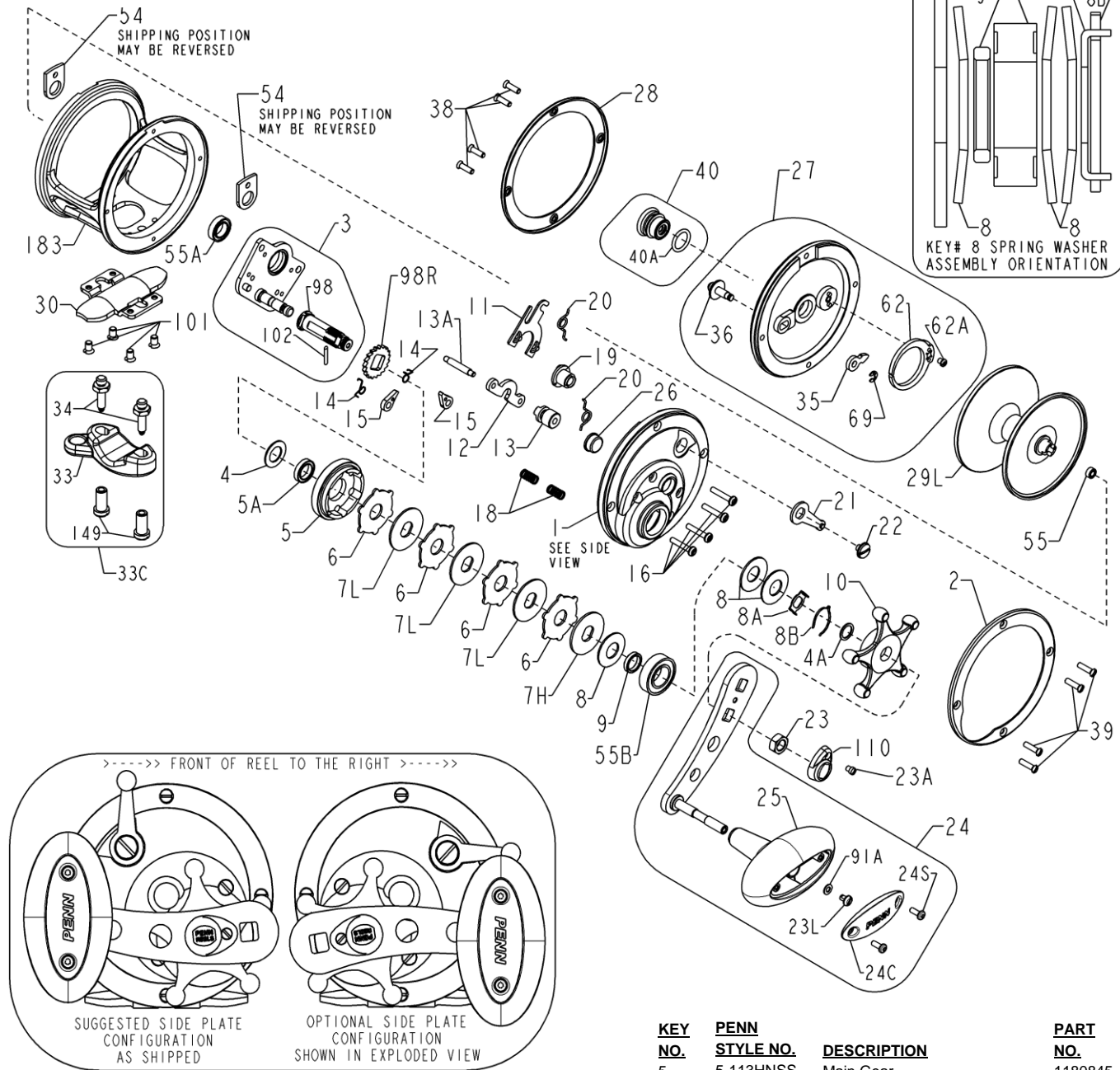

407-US113 Rev 1  
(1344369)  
ECN 1745 9-2-14

KEY NO.	PENN STYLE NO.	DESCRIPTION	PART NO.
1	1 113HN	Right Side Plate	1180453
2	2 113HNO	Right Side Ring	1180614
3	3 113HN	Bridge w/Sleeve	1180702
4	4 155	Fiber Washer	1180772
4A	4 300T	Graphite Washer	1180770

KEY NO.	PENN STYLE NO.	DESCRIPTION	PART NO.
5	5-113HNSS	Main Gear	1180845
5A	55-113HN	Main Gear Bearing	1183881
6	6-525MAG	Drag Washer (4 req)	1180922
7H	86-49H	Metal Drag Washer	1184250
7L	7-113HN	Metal Drag Washer (3 req)	1181009
8	18-505	Tension Spring Washer (3req)	1181623
8A	8-113HN	Click Spring Retainer	1181066
8B	10C-113HN	Detent Spring	1181219

KEY NO.	PENN STYLE NO.	DESCRIPTION	PART NO.
9	9-113HN	Spacing Sleeve	1181151
10	10-300T	Star Drag Wheel	1181193
11	11-113	Eccentric Jack	1181233
12	12-113HN	Pinion Yoke	1181261
13	13-113HNSS	Pinion	1181319
13A	13A-113HN	Pinion Sub Shaft	1181364
14	14-15KG	Dog Spring (2 req)	1181387
15	15-113HN	Dog (2 req)	1181436
16	16-113HN	Bridge Screw (4 req)	1181571
18	18-60	Clutch Spring (2 req.)	1181615
19	19-113HN	Eccentric	1181663
20	20-267	Eccentric Spring (2 req)	1181775
21	21-113HN	Eccentric Lever	1181844
22	22-60CH	Eccentric Screw	1181908
23	23-555	Handle Nut	1181950
23A	32-15	Handle Lock Screw	1182708
23L	23L-750	Knob Screw	1191283
24	24S-US113	Handle Assembly	1348355
24C	24C-SQL50LW	Knob Cap	1286717
24S	24S-TRQ40NLD2	Screw (2 req)	1265021
25	25-SQL50	Handle Knob	1286716
26	26-113HN	R.S. Bearing	1182117
27	27-US113	Left Side Plate Asm	1344323
28	28-113HNO	Left Side Ring	1182372
29L	29L-US113	Spool	1339942
29L	29L-US113N	Spool	1339943
29L	29L-US113W	Spool	1339944
30	30-12LT	Stand	1182597
33	33-113	Rod Clamp	1182754
33C	33C-113HN	Rod Clamp Kit	1182774
34	34-975	Clamp Scrw (2 req)(Stndr)	1182839
*	*34-113HN	Clamp Scrw (2 req)(Optnl)	*1191623
35	35-60	Click Tongue	1182901
36	36-113	Click Button	1182989
38	32-17	Left Side Plate Screw (4 req)	1182710
39	39-3	Right Side Plate Screw (4 req)	1183178
40	40N-113HL	L.S. Bearing Assembly	1197542
40A	120-113H	O-Ring	1184522
54	54-113HN	Harness Lug (2 req)	1192018
55	55-910	Bearing	1183894
55A	26A-25FR	Bearing	1182133
55B	55-12H	Bearing	1183873
62	62-309	Click Spring	1184028
62A	63-209	Click Spring Screw	1184048
69	69B-600	Retaining Ring	1184129
91A	91A-TRQ40NLD2	Washer	1277514
98	98-113HN	Gear Sleeve	1184333
98R	98R-113HN	Antireverse Ratchet	1184390
101	101-80ST	Stand Screw (4 req)	1184405
102	102-60	Gear Sleeve Pin	1184408
110	110A-555	Handle Nut Cap	1184442
149	149-45	Rod Clamp Nut (2 req) (Stndr)	1184702
*	*149-113HN	Rod Clamp Nut (2 req) (Optnl)	*1202076
183	183-US113	Frame	1339951
183	183-US113N	Frame	1339952
183	183-US113W	Frame	1339953

\* Not Shown