

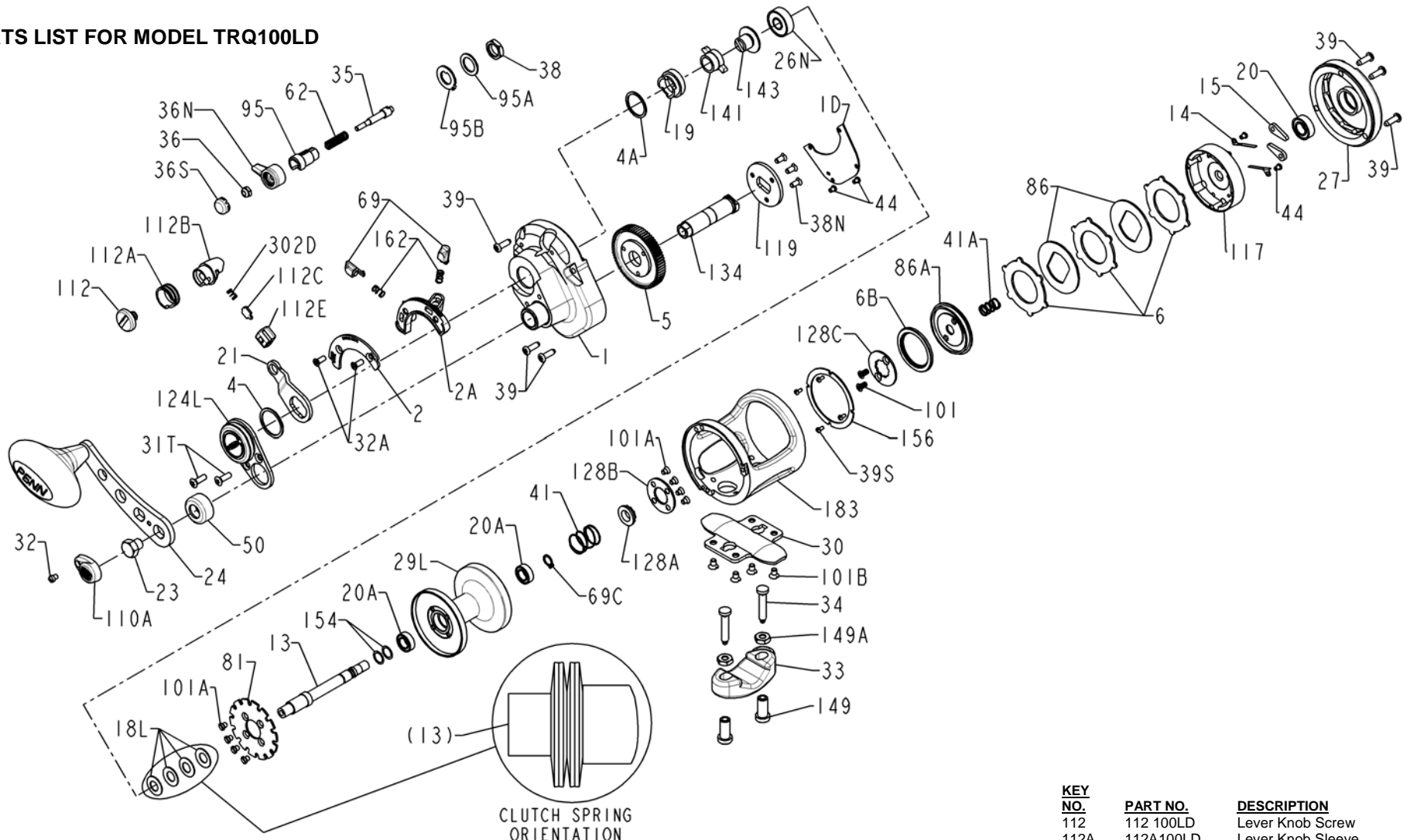

PARTS LIST FOR MODEL TRQ100LD



| KEY NO. | PART NO. | DESCRIPTION |
|---------|-----------|----------------------------|
| 1 | 001 100LD | Right Side Plate |
| 1D | 001D100T | Backing Plate |
| 2 | 002 100LD | Drag Lever Quadrant |
| 2A | 002A100LD | Drag Lever Ratchet |
| 4 | 004 012LT | Drag Lever Thrust Washer |
| 4A | 004 300LD | Cam Thrust Washer |
| 5 | 005 100LD | Main Gear |
| 6 | 006 100LD | Drag Washer (3 Req) |
| 6B | 006B100LD | Drag Engagement Washer |
| 13 | 013 100LD | Pinion |
| 14 | 014 100LD | Dog Spring (2 Req) |
| 15 | 015 100LD | Anti-Reverse Dog (2 Req) |
| 18L | 018L300LD | Clutch Spring (4 Req) |
| 19 | 019 300LD | Cam |
| 20 | 020 722 | Left Side Ball Bearing |
| 20A | 020 4200 | Spool Ball Bearing (2 Req) |

| KEY NO. | PART NO. | DESCRIPTION |
|---------|-----------|------------------------------|
| 21 | 021 100LD | Drag Lever |
| 23 | 023 300LD | Handle Screw |
| 24 | 024 200LD | Handle Assembly |
| 26N | 026N025 | Right Side Ball Bearing |
| 27 | 027 100LD | Left Side Plate |
| 29 | 029L100LD | Spool |
| 30 | 030 016VS | Stand |
| 31T | 031T070 | Screw (2 Req) |
| 32 | 032 015 | Handle Cap Screw |
| 32A | 032 100LD | Quadrant Screw (2 Req) |
| 33 | 033 113 | Rod Clamp |
| 34 | 034 016VS | Rod Clamp Screw (2 Req) |
| 35 | 035 100LD | Click Tongue |
| 36 | 036 700 | Click Button Nut |
| 36N | 036N050 | Click Button |
| 36S | 036S080ST | Click Button Cap |
| 38 | 038 710 | Click Bushing Nut |
| 38N | 038N007 | Coupling Plate Screw (3 Req) |

| KEY NO. | PART NO. | DESCRIPTION |
|---------|-----------|---------------------------|
| 39 | 039 300LD | Left Side Screw (6 Req) |
| 39S | 039S965 | Drag Cover Screw (4 Req) |
| 41 | 041 100LD | Drive Clutch Spring |
| 41A | 041A100LD | Drag Disengagement Spring |
| 44 | 044 300T | Screw (4 Req) |
| 50 | 050 025 | Gear Stud Shield |
| 62 | 062 300LD | Click Spring |
| 69 | 069 012VS | Locating Pin (2 Req) |
| 69C | 069C015KG | Retaining Ring |
| 81 | 081 100LD | Click Ratchet Plate |
| 86 | 086 100LD | Keyed Drag Washer (2 Req) |
| 86A | 086A100LD | Drag Bushing |
| 95 | 095 100LD | Click Bushing |
| 95A | 095A020 | Click Bushing Washer |
| 95AB | 095AB050 | Click Locking Plate |
| 101 | 101 030 | Mounting Screw (2 Req) |
| 101A | 101 050S | Mounting Screw (8 Req) |
| 101B | 101 080ST | Stand Screw (4 Req) |
| 110 | 110A555 | Handle Screw Cap |

| KEY NO. | PART NO. | DESCRIPTION |
|---------|------------|-----------------------------|
| 112 | 112 100LD | Lever Knob Screw |
| 112A | 112A100LD | Lever Knob Sleeve |
| 112B | 112B100LD | Lever Knob |
| 112C | 112C030VS | Click Plate |
| 112E | 112E100LD | Lever Click Housing |
| 117 | 117 100LD | Drag Housing |
| 119 | 119 050 | Coupling Plate |
| 124L | 124L100LD | Bridge Cover Assembly |
| 128A | 128A100LD | Driver |
| 128B | 128B100LD | Drive Plate |
| 128C | 128C100LD | Driver Retainer |
| 134 | 134 200LD | Gear Stud |
| 141 | 141 300LD | Cam Follower |
| 143 | 143 300LD | Adjusting Screw |
| 149 | 149 045 | Rod Clamp Nut (2 Req) |
| 149A | 149 200 | Hex Nut (2 Req) |
| 154 | 154 100LD | Spool Shim (2 as Required) |
| 156 | 156 100LD | Drag Housing Cover |
| 162 | 162 100LD | Locating Pin Spring (2 Req) |
| 183 | 183 100LD | Frame |
| 183 | 183 100LDE | Frame (for European models) |
| 302D | 302D525MAG | Lever Knob Spring |