

4 Determine the parts needed for your door.

Look at the hole in your door.
What shape is your torque blade (the part sticking out through the latch)?

D-shape

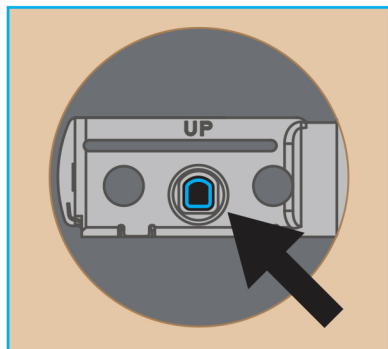

Kwikset and Weiser deadbolts:

Use kit "A" for your door.



Baldwin Reserve and Baldwin Prestige deadbolts:

Use kit "B" for your door.

You will need the black adapter and the thicker gold screws.

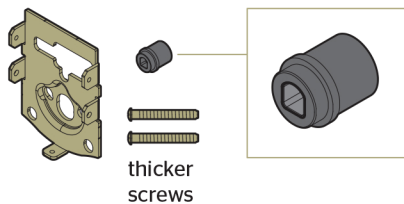

Vertical rectangle

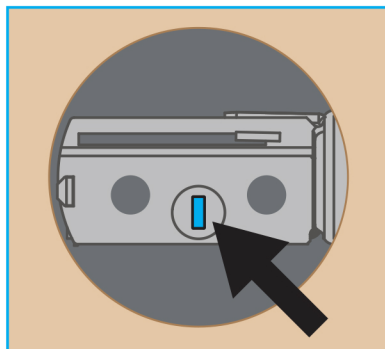

Baldwin Estate deadbolts:

Use kit "B" for your door.

You will need the gold adapter and the thinner gold screws.

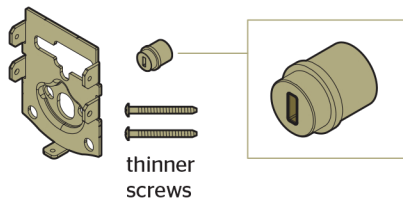

Slanted rectangle

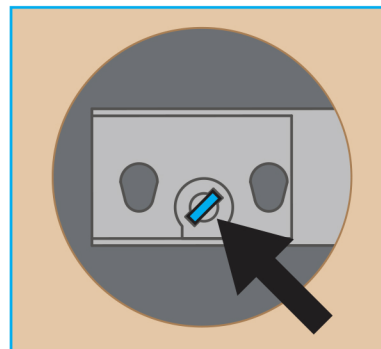

Schlage deadbolts:

Use kit "C" for your door.

You will need the silver adapter.

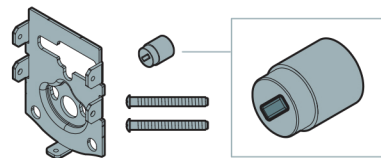

Horizontal rectangle

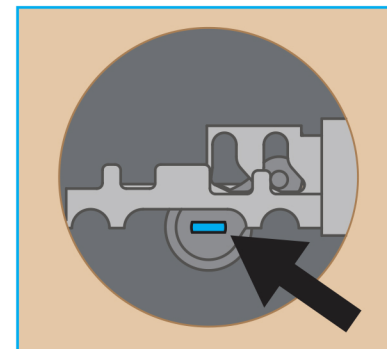

Schlage deadbolts:

Use kit "C" for your door.

You will need the gold adapter.

