

FOR DEEP TROLLING

PENN REELS®
FATHOM·MASTER®
ELECTRIC DOWNRIGGER
800-820



PLEASE TAKE TIME TO
CAREFULLY READ THIS MANUAL.
PLEASE KEEP THIS MANUAL SAFE
AND DRY FOR FUTURE REFERENCE.

815 DRH
DUAL ROD HOLDER
PARTS AND INSTALLATION

MOUNTING INSTRUCTIONS

There are two stages in the installation of the 815 DRH dual rod holder. The first stage is installing the frame bracket. The second stage is installing and adjusting the individual rod holder tubes and brackets.

Carefully read the entire instructions and study the exploded view before beginning installation and/or drilling any holes.

INSTALLING FRAME BRACKET (IF DOWNRIGGER FRAME HAS FOUR PRE-DRILLED HOLES)

If there are already four pre-drilled holes in the frame, position the frame bracket (key no. 5) to line up the holes in both the bracket and frame.

Position the large square backing plate (9) in the inner portion of the frame so that the backing plate's large oval hole matches the large hole in the frame bracket. Position the small rectangular backing plate (10) over the two right side holes in the frame bracket, and use two of the three 7/8" slotted pan head screws (11, the screws with the smaller diameter heads), along with two of the five lock nuts (1) to attach the frame bracket. Temporarily tighten finger tight.

Use the third 7/8" slotted pan head screw (11), a flat washer (2) and another lock nut (1) to install the screw in the upper left hand hole in the frame bracket. Temporarily tighten finger tight.

Remove the boom screw (14, on the 800-820 unit), for this screw will help to support the frame bracket further.

Now position the L-shaped support bracket, (6) so that its two bottom holes line up with the two holes in the frame bracket. At the same time, the hole on top of the L-bracket will line up with the boom screw hole. Re-insert the boom screw and temporarily finger tighten.

Use the two short (5/8") pan head screws (12), the two remaining flat washers (2) and the two remaining lock nuts (1) to secure the L-bracket. Temporarily tighten finger tight.

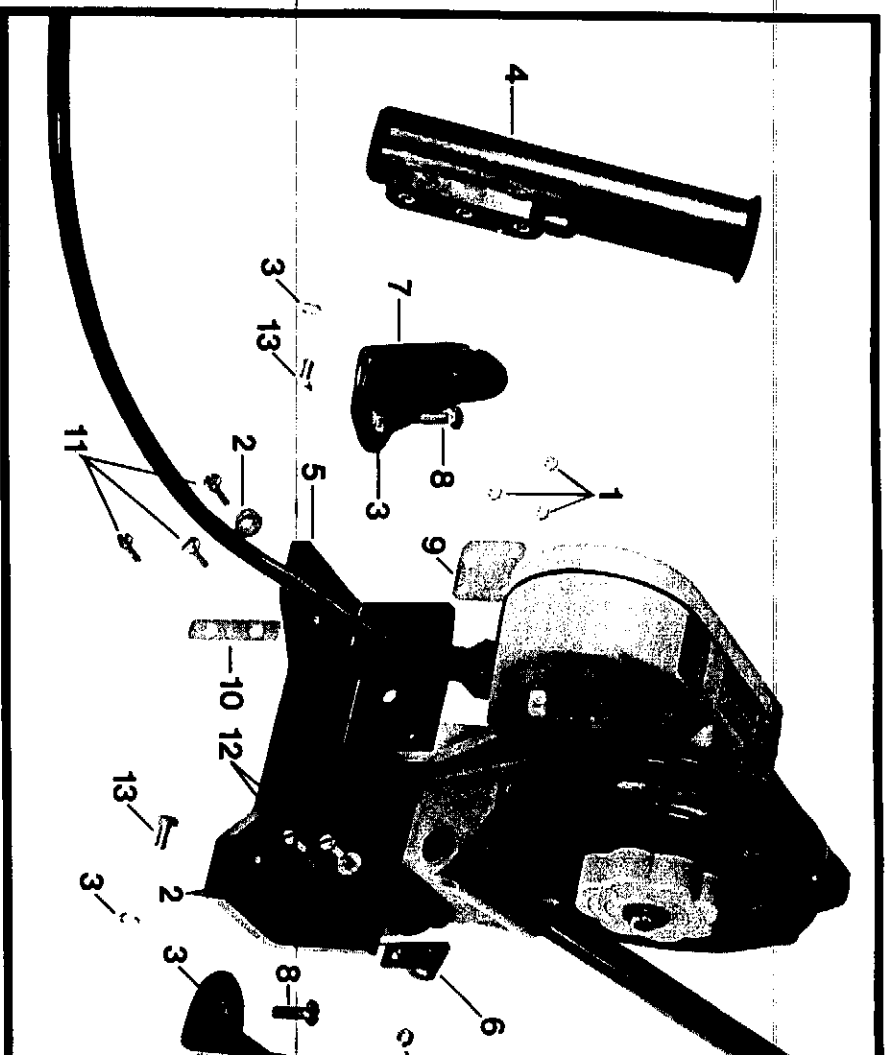

Tighten all five screws and nuts (and boom screw) uniformly and firmly, but be careful not to over-tighten and risk stripping the threads or damaging the screw heads or nuts.

INSTALLING FRAME BRACKET (IF DOWNRIGGER FRAME HAS ONE PRE-DRILLED HOLE)

If there is only one hole in the frame, then you must drill three more holes, using the frame bracket as a template.

Temporarily mount the frame bracket by installing one of the three 7/8" pan head screws (key no. 11) through the bracket and one matching hole in the frame. Use a flat washer (2) and lock nut (1) to secure the screw. For now, tighten only finger tight.

Install the L-shaped support bracket (6) by first removing the boom screw (14, on the 800-820 unit) and position the L-bracket so that its two bottom holes line up with the two holes on the frame bracket. At the same time, the hole in the top of the

L-bracket will line up with the boom screw hole. Re-insert the boom screw and temporarily finger tighten.

Use the two short (5/8") pan head screws (12), two flat washers (2), and two lock nuts (1) to secure the L-bracket. Temporarily finger tighten.

Before temporarily tightening the frame bracket and supporting bracket to the frame, make sure that the frame bracket is level (parallel) with the bottom edge of the downrigger frame. Also make sure that both edges of the slot are an equal distance from the supporting rib on the frame. (Don't position the bracket flush right or flush left to the supporting rib.) Tighten the screws/nuts only enough to prevent the bracket from slipping.

Using the frame bracket holes as a guide, make three punch holes in the downrigger frame. For the most accurate installation, use a center punch, awl or small sharp nail. Make sure the punch holes are centered.

Drill three 1/4" holes in the frame, being careful to drill perpendicular to the frame surface in that area. You can insert a scrap piece of wood in the inner portion of the downrigger frame

815 DRH

DUAL ROD HOLDER

PARTS AND INSTALLATION

PARTS LIST FOR 815 DUAL ROD HOLDER

KEY NO.	PART NO.	DESCRIPTION	QUANTITY
1	208-815	Lock Nut	5
2	220-600	Flat Washer (1/4")	3
3	254-810	Split Lock Washer (5/16")	4
4	256-815	Rod Holder Tube	2
5	258-815	Frame Bracket	1
6	258A-815	Support Bracket	1
7	259-815	Rod Holder Bracket	2
8	260-810	Large Diameter Pan Head Screw	2
		(5/16"-24 x 7/8")	
9	265-815	Backing Plate (Square)	1
10	265A-815	Backing Plate (Rectangular)	1
11	267-815	Small Diameter Pan Head Screw	3
		(1/4"-20 x 7/16")	
12	267A-610	Pan Head Screw	2
		(1/4"-20 x 5/8")	
13	268-815	Hex Head Bolt	2
		(5/16"-24 x 5/8")	
14	194-600	Boom Screw	1
		(on 800-820 unit)	

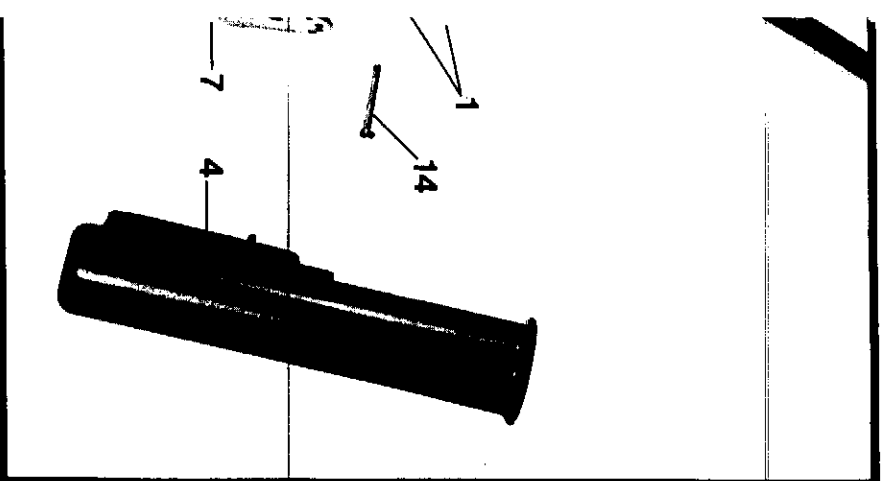

to protect it when the drill bit comes through. The frame bracket can be left on or taken off while drilling.

After drilling, remove the temporary screw/washer/nut and use the three 7/8" pan head screws (11, the screws with the smaller diameter heads) to attach the frame bracket to the frame. Before securing the lock nuts to the screws, make sure the two backing plates are in position. The large backing plate (9) goes in the inner portion of the downrigger frame, so that the three smaller holes match the three holes you just drilled in the downrigger frame. The large oval hole in the backing plate will now match the larger hole in the frame bracket. Note: This hole is for the shackle of a bicycle padlock if you want to lock your downrigger to the boat. The small rectangular backing plate (10) goes on the frame bracket. And the remaining flat washer (2) goes underneath the head of the screw in the upper left hand hole in the frame bracket. Tighten all screws/lock nuts securely, but be sure not to over-tighten and risk stripping the threads or damaging the screws/nuts.

INSTALLING AND ADJUSTING ROD HOLDER BRACKETS AND ROD HOLDERS

Temporarily install the two rod holder brackets (7) to the frame bracket using the two 7/8" pan head screws (8, the screws with the larger diameter heads) and two split lock washers (3). Tighten only finger tight, because you will probably want to adjust the bracket's angle after you install the rod holder tube (4).

Temporarily install a rod holder tube on each rod holder bracket using the two hex head bolts (13) and the two remaining split lock washers. Again, tighten only finger tight to allow for adjustment to the rod holder angle you desire.

Both the rod holder brackets and rod holder tubes can adjust to a number of different angles by inserting the pins, which are already molded into each bracket and tube, into one of the corresponding holes in the frame bracket and rod holder brackets.

Experiment with different positions to get the angles you prefer the most, then tighten both the two pan head screws (use a large screw-

driver for secure installation and extra clearance) and the two hex head bolts (use a 1/2" wrench). Tighten firmly, but be sure not to over-tighten and risk stripping the threads or damaging the screw/bolt heads.

After you have used the dual rod holder for a while, check to make sure that all hardware is still firmly tightened. Re-adjust the angles of the rod holder tubes/brackets anytime you want to, but always re-check the hardware for tightness. When making adjustments, back off the bolts/screws just far enough to allow for the adjustments. If the bolts/screws are backed out too far, you may back them out completely and risk losing them. Never try to make adjustments while fishing rods are in the dual rod holder. It's amazing how unwieldy even a lightweight rod can get if it's in one of the rod holder tubes while you're trying to get the right angle. Instead, estimate the angle you want, remove the rod, make your adjustment, and then put the rod back into the holder to check the angle. That's the easy, smart and tackle-saving way to do it.