

# PC-01 Self tapping clip set PC-M1B + PC-F1A

INDUSTRY FIT:



SPECIFICATION:

STANDARD RANGE

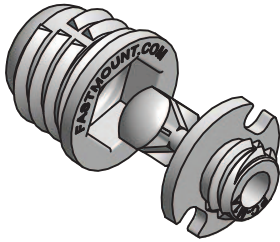

USE WITH:

PC-RF1

PC-SF1

PC-M2H

PC-VM1

PC-SM2



PC-VMX

PC-SM2H



MATERIAL: White acetal copolymer

MORE INFO: Installation Guide IG\_PC-F1, Setout Guide TD-02, 09, 12

The Fastmount™ multi-award winning system has revolutionized the mounting of panels. Panels can easily be removed and refitted in any sequence time after time.

Self tapping clip products PC-F1A & PC-M1B make up the PC-01 clip set. These core products work with our range of standard clips designed for adhesive fix, heavy duty, high shear strength and variable gap requirements.

## BENEFITS

- Self-aligning installation without adhesives
- Perfect panel alignment secure mounting every time
- Remove and refit panels in any sequence 200+ times
- Saves time and reduces cost
- 5 & 10kg pull out load per clip
- Allows for flexing and expansion of panel and support frame

## APPLICATIONS

- Suitable for covered or painted & prefinished panels
- Ceiling and wall panels
- Exterior panels
- Refits and upgrades of existing installations
- Install into a variety of substrates
- Mounting options for composites and thin-walled panels

INSTALLATION: Partially exploded section through showing typical installation method

