

Programming

IMPORTANT: Before any programming sequence, make sure that your door is open and unlocked.

For all programming sequences below, success is indicated when the **Kwikset** button flashes green 2 times and you hear 2 beeps.

If unsuccessful, the **Kwikset** button will flash red 3 times and you will hear 3 beeps.

Note: If the lock is muted, you will not hear the lock beeping.

How to change your Programming Code

The Programming Code (PC) will not unlock your door. It is an added security feature that is used to set up all functions. The default PC is 0-0-0-0. It is recommended that you change it to a code of your own.

1. Enter your existing PC.

2. Press   

3. Enter a new PC. It must be between 4 and 10 digits.

4. Press 

How to add User Codes

A total of 6 User Codes (and a temporary one-time User Code) may be programmed. Do not program a User Code that is the same as your PC.

1. Enter your PC.

2. Press   

3. Enter a new User Code. It must be between 4 and 10 digits.

4. Press 

5. Test the code: While your door is open, lock it and enter your new User Code to make sure it unlocks the door.

How to delete individual User Codes

The lock is pre-programmed with a default User Code of 1-2-3-4. It is recommended that you delete this code.

1. Enter your existing PC.

2. Press   

3. Enter the User Code you wish to delete.

4. Press 

5. Test the code: While your door is open, lock it and enter the User Code to make sure it no longer unlocks the door.

How to add a one-time User Code

A one-time user code may be used only once, and then it will be deleted immediately after use.

1. Enter your existing PC.

2. Press **Kwikset** **9** **Kwikset**

3. Enter a new User Code. It must be between 4 and 10 digits.

4. Press **Kwikset**

How to enable/disable User Codes

If User Codes are disabled (example: when you go on vacation), the lock can only be operated by the key and turnpiece until they are enabled again.

1. Enter your PC.

2. Press **Kwikset** **8** **Kwikset**

3. Repeat steps 1 and 2 to enable or disable the codes again.

How to delete all User Codes

If all User Codes are deleted, the lock can only be operated by the key and turnpiece until a new User Code is added.

1. Enter your existing PC.

2. Press **Kwikset** **3** **Kwikset**

How to enable/disable Auto-Lock

The Auto-Lock feature automatically re-locks your door 30 seconds after unlocking. This feature is off by default.

1. Enter your existing PC.

2. Press **Kwikset** **5** **Kwikset**

3. Repeat steps 1 and 2 to enable or disable Auto-Lock again.

How to change Auto-Lock time delay

You can set the Auto-Lock time delay between 10 and 99 seconds.

1. Enter your PC.

2. Press **Kwikset** **6** **Kwikset**

3. Enter time between 10 and 99 seconds.

4. Press **Kwikset**

How to mute/unmute lock

If the lock is muted, you will not hear beeping during programming, normal operation, low battery indicators or system alerts.

1. Enter your existing PC.

2. Press **Kwikset** **7** **Kwikset**

3. Repeat steps 1 and 2 to mute or unmute the lock again.

How to restore default settings

This procedure will delete all User Codes associated with the lock, and the default PC and User Code will be restored.

1. Press and hold the Reset button for 5 seconds, until you hear 3 beeps and see the **Kwikset** button flash amber 3 times.

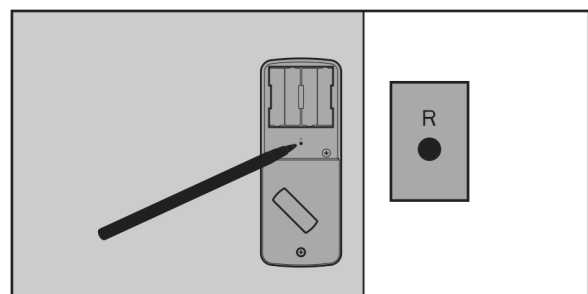

2. Enter the default PC (0-0-0-0).

3. Enter the door handing code to re-teach the lock the orientation of the door:

Kwikset **0** **Kwikset**

4. Test the lock: With the door open and unlocked, press the **Kwikset** button to make sure it locks the door.

5. Test the default User Code: Enter the default User Code (1-2-3-4), and make sure it unlocks the door.